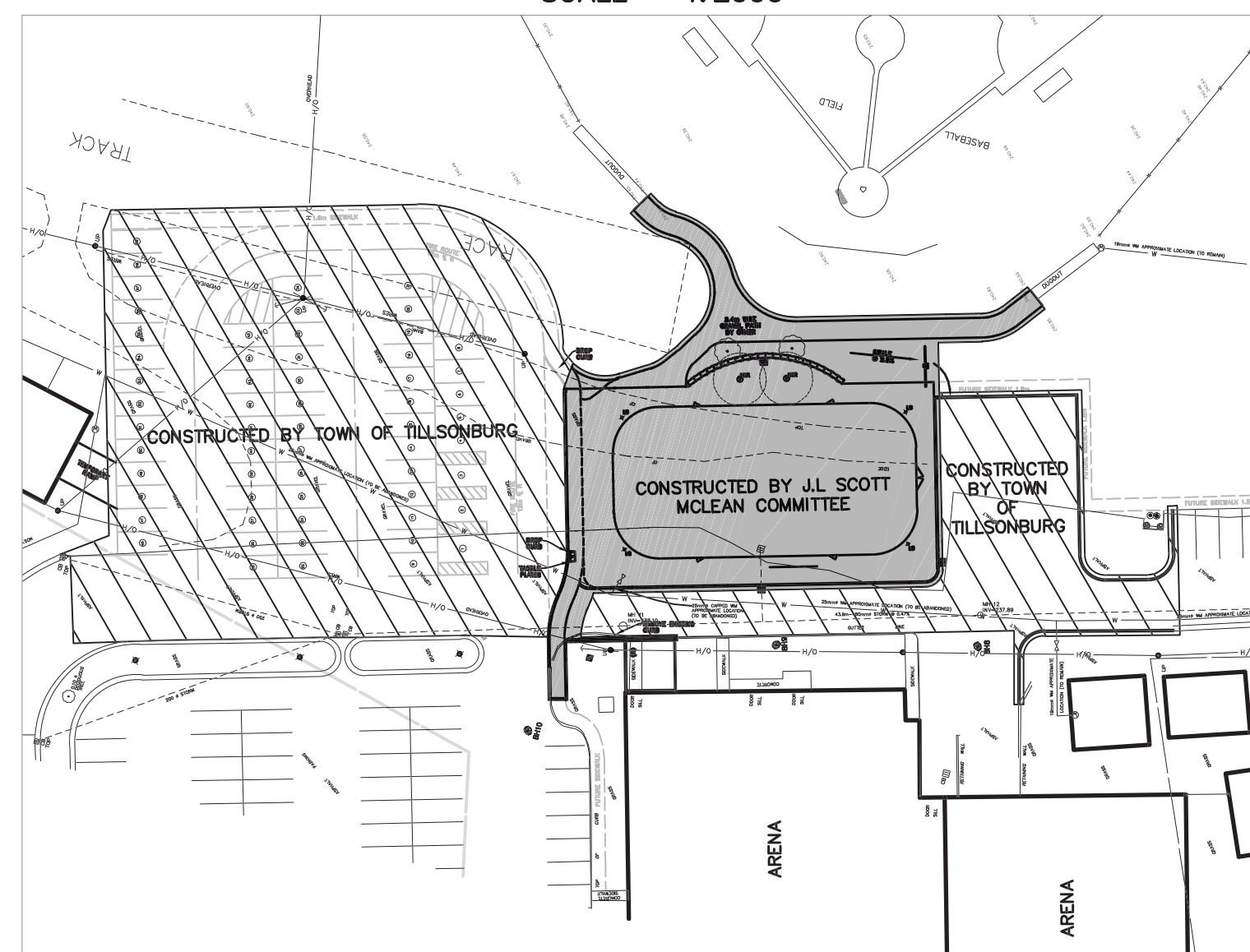
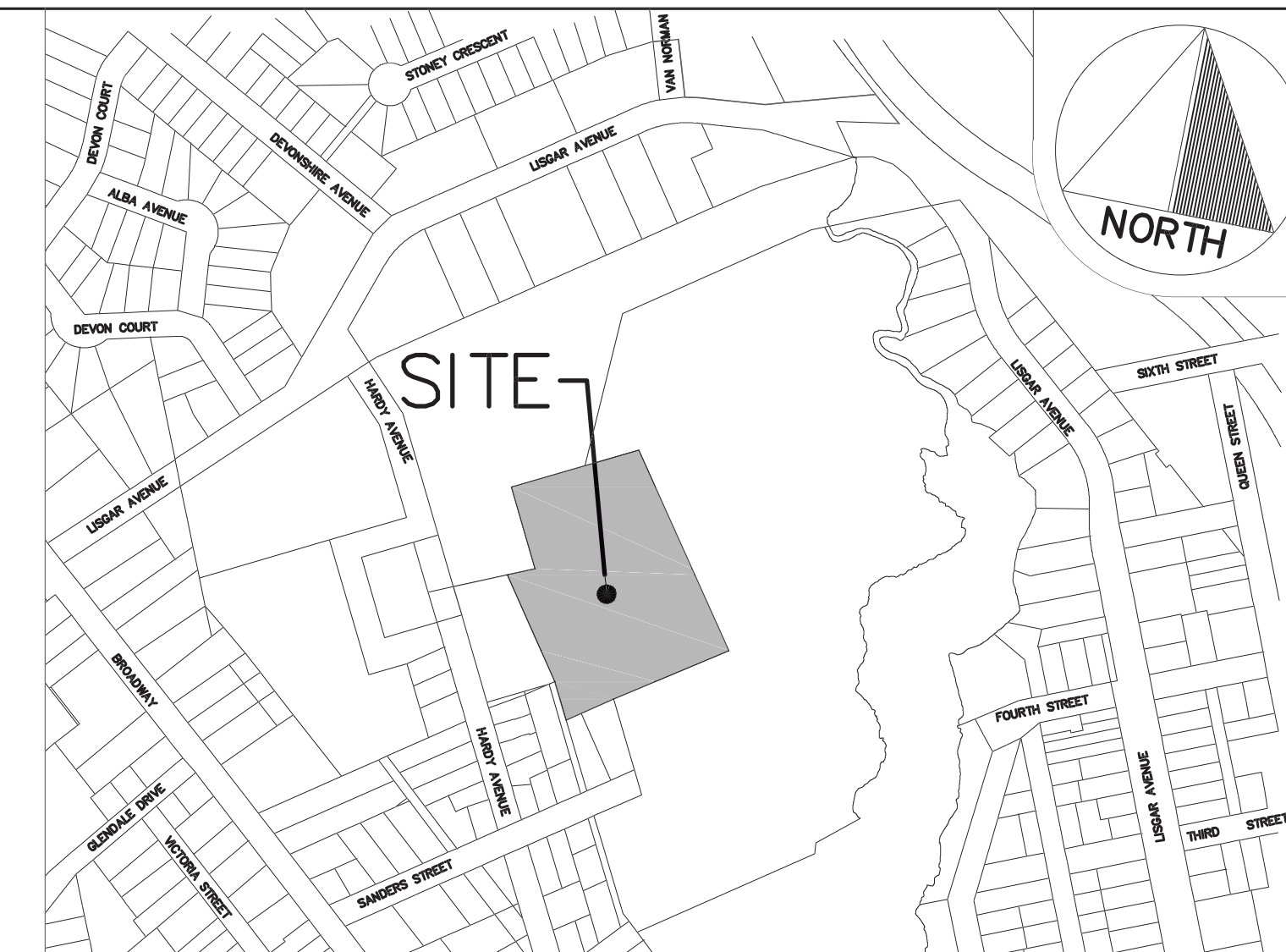
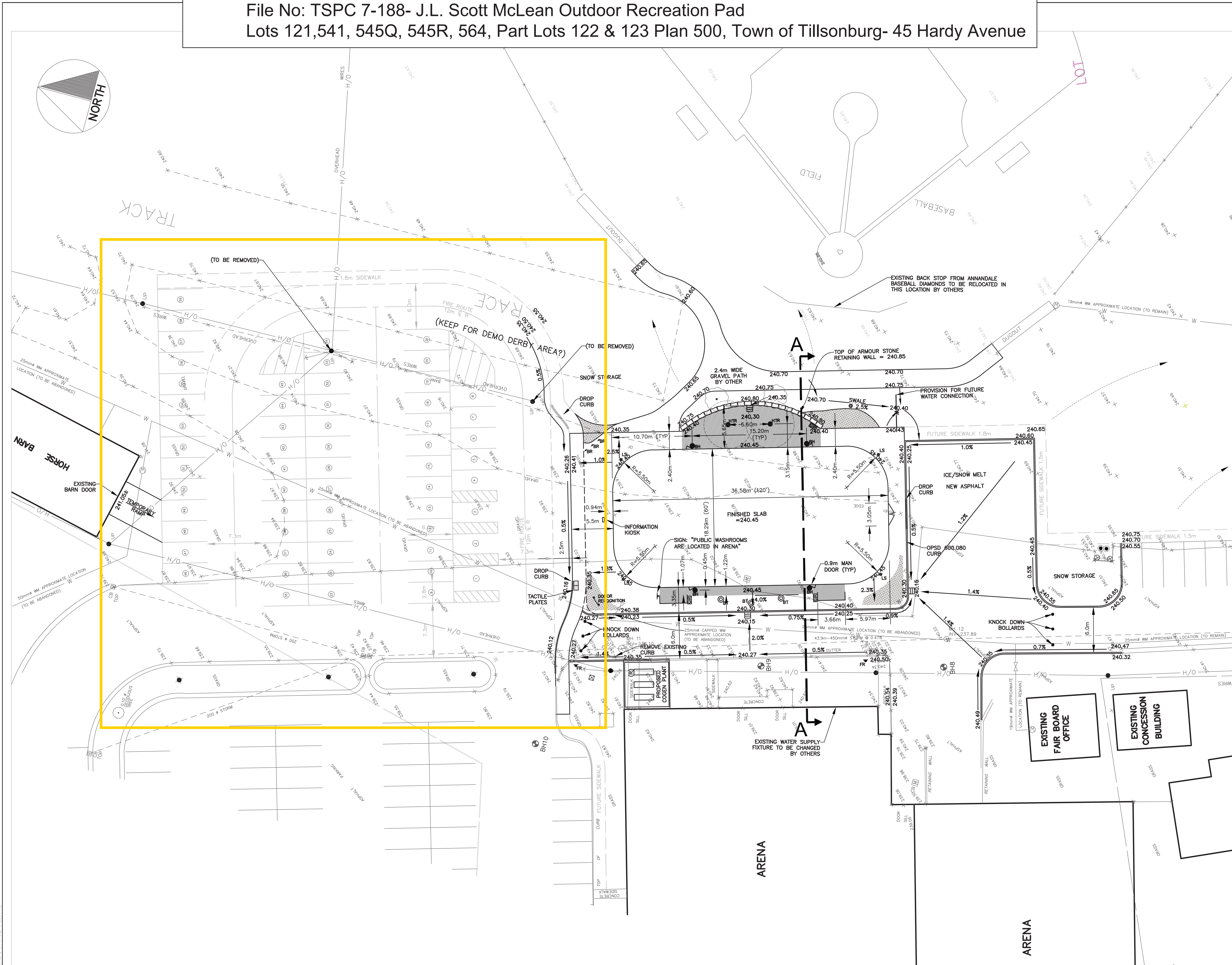
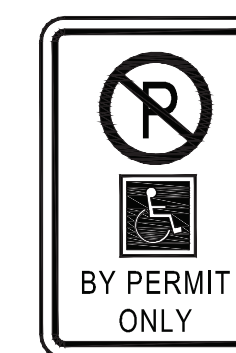

Plate 1: Proposed Grading Plan
File No: TSPC 7-188- J.L. Scott McLean Outdoor Recreation Pad
Lots 121,541, 545Q, 545R, 564, Part Lots 122 & 123 Plan 500, Town of Tillsonburg- 45 Hardy Avenue



GENERAL NOTES

1. THE LOCATION OF UTILITIES IS APPROXIMATE FROM ADJACENT ROAD RECONSTRUCTION PROJECTS. IT IS THE RESPONSIBILITY OF THE PLAN USER TO INFORM THEMSELVES OF THE EXACT LOCATION OF ALL PUBLIC UTILITIES, INCLUDING WATER MAINS, SEWERS, AND OTHER UNDERGROUND AND OVERHEAD UTILITIES AND STRUCTURES BEFORE COMMENCING WORK. SUCH UTILITIES AND STRUCTURES ARE NOT NECESSARILY SHOWN ON THE DRAWINGS, HEREIN. WHERE SHOWN THE ACCURACY OF THE POSITION IS NOT GUARANTEED. THE CONTRACTOR SHALL ASSUME LIABILITY FOR DAMAGES TO THE UTILITIES DURING CONSTRUCTION.
2. ELEVATIONS ARE REFERRED TO THE TOP NUT OF FIRE HYDRANT AT THE SOUTHWEST CORNER OF HARDY AVENUE AND SANDERS STREET HAVING AN ELEVATION OF 240.41m.
3. ASPHALT DESIGN: 300mm GRAN "B"
100mm GRAN "A"
40mm HLB HOT-MIX ASPHALT
50mm HLB HOT-MIX ASPHALT
4. CATCHBASINS SHALL CONFORM TO OPSD 705.010 WITH OPSD 400.1040 FRAMES AND GRATES. CATCHBASIN LEADS SHALL HAVE CLASS "B" BEDDING.
5. SLOPE SLOPES SHALL BE 4:1 MAXIMUM (NOT-BOTTOM ACCEPTABLE, UNLESS NOTED OTHERWISE).
6. THE OWNER'S CONSULTING ENGINEER SHALL CERTIFY IN WRITING THAT ALL STEWARDS, GRADING AND SERVING HAS BEEN CONSTRUCTED IN ACCORDANCE WITH THE APPROVED SITE AND GRADING PLAN.
7. THE INSTALLATION AND CONSTRUCTION OF STORM SEWERS AND ROADWORKS SHALL BE IN ACCORDANCE WITH THE TOWN OF TILLSBORG SUBDIVISION AND DEVELOPMENT GUIDELINES, DESIGN CRITERIA.
8. ALL INSTALLATIONS TO CONFORM TO TOWN OF TILLSBORG STANDARD SPECIFICATIONS.
9. ALL WATER AND SANITARY WORKS SHALL BE IN ACCORDANCE WITH OXFORD COUNTY DESIGN GUIDELINES AND SPECIFICATIONS FOR MUNICIPAL SERVICES. THE INSTALLATION AND CONSTRUCTION OF STORM SEWERS AND ROADWORKS SHALL BE IN ACCORDANCE WITH THE TOWN OF TILLSBORG, SUBDIVISION AND DEVELOPMENT GUIDELINES, DESIGN CRITERIA.
10. THE CONTRACTOR MUST OBTAIN AN ENCROACHMENT PERMIT PRIOR TO ANY WORK BEING PERFORMED WITHIN THE TOWN'S RIGHT-OF-WAY.



Rb-93



TOWN OF TILLSONBURG PARKING REQUIREMENTS

| | | |
|--------------------------------------|-----------------------|----------|
| NEW DRIVE ASPHALT | 1084.38m ² | |
| NEW PARKING ASPHALT | 2373.17m ² | |
| | REQUIRED | PROVIDED |
| HANDICAPPED – 4% OF TOTAL = 2 | 3 | 3 |
| TOTAL PARKING | ?? | 59 |
| DEPTH (MIN.) | 5.5m | 5.5m |
| WIDTH (MIN.) | 2.7m | 2.7m |
| HANDICAPPED DEPTH (MIN.) – TYPE A | 5.5m | 5.5m |
| HANDICAPPED WIDTH (MIN.) – TYPE A | 3.4m | 3.4m |
| HANDICAPPED DEPTH (MIN.) – TYPE B | 5.5m | 5.5m |
| HANDICAPPED WIDTH (MIN.) – TYPE B | 2.7m | 2.7m |

TOWN OF TILLSONBURG

CJDL
Consulting Engineers

Cyril J. Demeyere Limited
P.O. Box 460, 261 Broadway
Tillsonburg, Ontario. N4G 4H8
Tel: 519-688-1000
866-302-9886
Fax: 519-842-3235
cjd1@cjd1eng.com

J.L SCOTT MCLEAN OUTDOOR RECREATION PAD TILLSONBURG COMMUNITY CENTRE TOWN OF TILLSONBURG GRADING PLAN

1